

ICECARE-10W **New**

Mobile Sales Assistant

- 10.1" TFT LCD with resistive touch
- Intel® Atom™ N2800 1.86GHz processor
- Powered by Windows® Embedded Standard 7 P
- Built-in Bluetooth and Wi-Fi
- Built-in smart card reader and magnetic stripe card reader
- Optional 2D barcode reader, 13.56MHz RFID reader



Applications

The ICECARE-10W is designed to suit the hospitality industry, specifically for restaurant, hotel, and retail applications. Powered by the Intel® Atom™ N2800 processor and Windows® Embedded Standard 7 operating system, the ICECARE-10W is integrated with all the functions that a traditional fixed POS system has – a barcode reader, an RFID reader, a smart card reader, and a magnetic stripe card reader. It offers an all-in-one mobile solution for services that are looking for a stylish yet durable device.



Retail Store Management



Hotel Registration System



Restaurant Table Order Management



Drive-through (Fast Food)

1

IEIMobile Solutions

2

Automation Panel Solutions

3

PACSmate Medical Solutions

4

Optional Peripherals

Hybrid Card Reader

The ICECARE-10W comes integrated with a smart card reader and a magnetic stripe card reader for payment and identification purposes.



• Magnetic Stripe Reader (MSR) (optional)

EIA/TIA-232 Compliant
Card Speed 3 to 60 in/s (7.6 to 152.4 cm/s) - Reads single, dual or triple track
ISO 7811 Conformance (AGC (Automatic Gain Control) – Reads cards from 30% - 200% of ISO 7811 amplitude standard
9600 bps, 8 Data Bits, No Parity, 1 Stop Bit
Support HW encryption

• Smart Card Reader (SCR) (optional)

EMV V4.1 Level 1 Compliant
Supports ISO 7816 T=0, T=1 Smart Card. (Supports commonly used memory card.)
Card Interface ISO 7816 part 1, 2 and 3 Compliant
Card Interface Communication Speed up to 115200 bps

Smart Card Reader Application:

Smart cards utilize embedded computer chip technology to store and transact data between users. Stored data can range from anything associated with either value or information or both. Smart card systems offer great convenience and security to any transaction. Today, these systems are seen throughout in key applications including loyalty programs, personal identification verification, and payment.

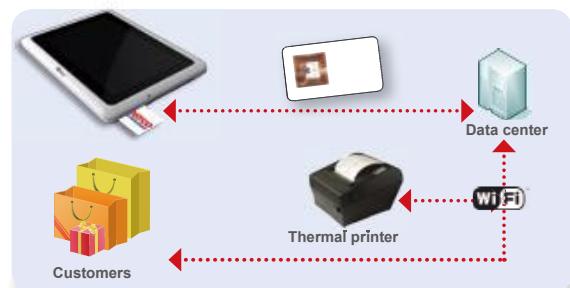

Magnetic Stripe Card Reader Application:

The information contained on the magnetic stripe is obtained by physical contact and swiping past a magnetic reading head in the magnetic stripe card reader. Magnetic stripe card systems are used in many important applications such as payment, loyalty programs, and personal identification verification.

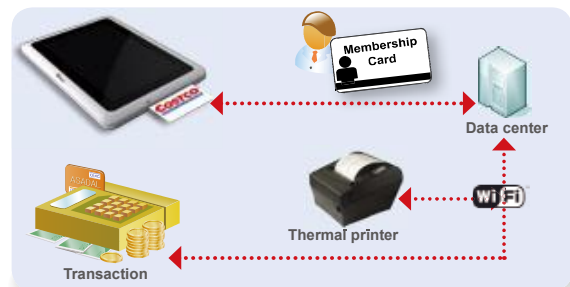

Stylish All-in-One Mobile Point-of-Service Design

The ICECARE-10W is a one-of-its-kind tablet PC. It offers a range of functions that a traditional fixed POS system has, such as the barcode reader, magnetic stripe card reader, and smart card reader. In addition, it is also stylishly designed to suit application contexts that place great importance on aesthetics. For example, such as those businesses in the fashion and hospitality industries.

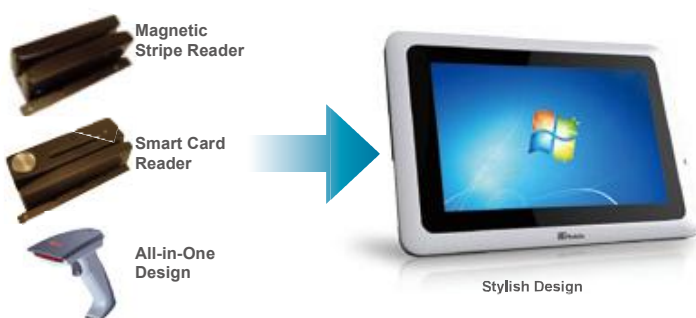

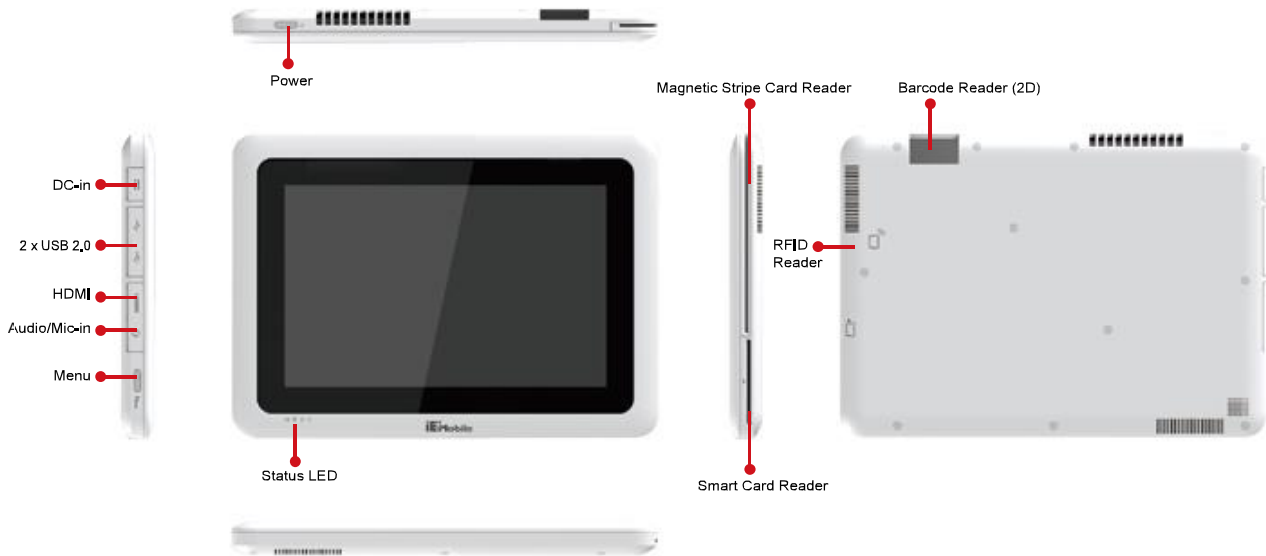

Specifications

Model		ICECARE-10W				
Display	LCD Size	10.1" TFT LCD		I/O Interface	Audio	1 x 1.5W Speaker
	Brightness (cd/m ²)	250			USB	2 x USB2.0
	Max. Resolution (HxV)	1280 x 800			Audio	1 x Audio/Mic-in
	Viewing Angle	75/75/75/70			Micro HDMI	1 x Micro HDMI
	Touch Screen	Resistive type			Expansions	Smart Card Reader (option) Magnetic Stripe Reader (option)
System	CPU	Intel® Atom™ N2800 1.86GHz		Power	Power Adapter	Input AC: 100-240V Output DC: 19V / 2.1A
	OS	Windows Embedded Standard 7 P			Battery	7.4V 7400mAh
	Memory	On-board 32 GB DDR3		Environment	Operating Temperature	0°C~40°C
Storage	Built-in 32GB mSATA		Storage Temperature		-20°C~60°C	
Communication	Wireless LAN	802.11b/g/n			Humidity	5%~95%, non-condensing
Data Collection	Bluetooth	Bluetooth v3.0		Environmental Protection	IP 54 compliant front panel	
	Barcode	1D/2D imager scan engine (optional)		Certification	CE / FCC	
Indicators & Buttons	RFID	13.56MHz RFID supports ISO 14443A/B (Mifare, Felica)		Physical	Dimensions (LxWxH) (mm)	290 x 206.5 x 22.5
	Keys	1 x Power button 1 x IEI menu			Weight	1.1 kg
	LED Indicators	Battery Charging/Peripheral Device/ Storage/Wireless				

Packing List

Item	Part No.	Q'ty
Power Adapter	63040-290040-000-RS	1

Ordering Information

Part No.	Description
ICECARE-10W-R10	Intel® Atom™ N2800 1.86GHz CPU, Resistive Multi-Touch, 4GB RAM, 32GB SSD, 802.11b/g/n, Bluetooth, 1D/2D Barcode, MSR, SCR, RFID, WS7P, RoHS
ICECARE-10W-ET-R10	Intel® Atom™ N2800 1.86GHz CPU, Resistive Multi-Touch, 4GB RAM, 32GB SSD, 802.11b/g/n, Bluetooth, RFID, WS7P, RoHS

Model Variations

Part No.	Touch	Wireless	Bluetooth	MSR	SCR	Barcode	RFID
ICECARE-10W-R10	Resistive Touch	802.11b/g/n	Ver. 2.1	Yes	Yes	Yes	Yes
ICECARE-10W-ET-R10	Resistive Touch	802.11b/g/n	Ver. 2.1	N/A	N/A	N/A	Yes

1

IEIMobile Solutions

2

Automation Panel Solutions

3

PACSmate Medical Solutions

4

Optional Peripherals